



ES 2,3-12

12V - 2,3Ah



Electrical specifications

| | | |
|-------------------------|--------------------|--------------------|
| Nominal Voltage | 12 V | |
| Capacity 25°C to 1,8V/c | 20 hour rate | 2,25 Ah |
| | 10 hour rate | 2,09 Ah |
| | 8 hour rate | 1,97 Ah |
| | 3 hour rate | 1,67 Ah |
| | 1 hour rate | 1,19 Ah |
| Self discharge @ 25°C | per month | 2,5 - 3 % |
| Internal Resistance | fully charged | approx 60 mΩ |
| Maximum current @ 25°C | charging | 0,69 A |
| | discharging (5sec) | 34 A |
| Charge Voltage @25°C | Float (-18mV/°C) | 2,27 - 2,29 V/Cell |
| Charge Voltage @25°C | Cyclic (-30mV/°C) | 2,41 - 2,48 V/Cell |

Other specifications

| | | |
|---------------------------------|--------------------------|--|
| Design Floating Life @ 20°C | 3-5 Years | |
| Dimensions LxWxH (± 1mm) | 178x35x61 mm | |
| Total height | 67 mm | |
| Operating Temperature (storage) | -20 to +50 °C | |
| Separator | Absorbent Glass Mat | |
| Grid alloy | Calcium / Tin lead alloy | |
| Case and cover | ABS / VDS | |
| Electrolyte | Sulphuric Acid | |
| Terminal / Length | .187 (F1) faston | |
| Optional terminal types | none | |
| Torque setting | none Nm | |
| Weight | 0,88 (±5%) kg | |

Innovative Features

- Completely maintenance free, sealed construction eliminates the need for adding water
- Fully tank formed plates
- Analytical grade electrolyte
- Spill proof / leak proof
- Valve regulated Max internal pressure 2,5 psi
- Multi-position usage
- ABS Case and cover (V0 optional)
- Low self discharge
- FAA and IATA approved as non-hazardous
- Built to comply with IEC 8962, DIN 43534, BS 6290 Pt4, Eurobat

Dimensions

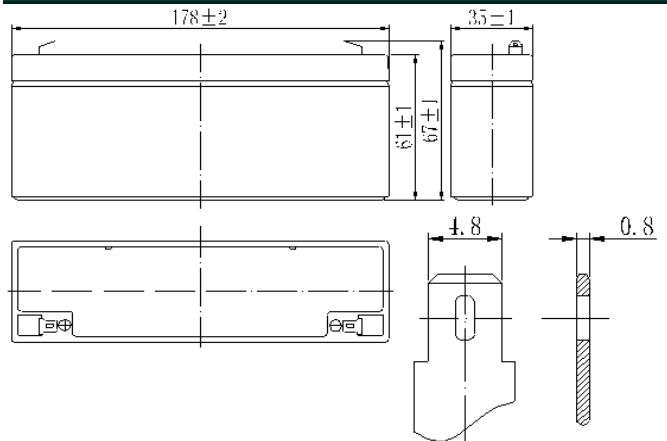

Constant Amps Discharge - Amps at 25°C

| V/Cell | 5m | 10m | 15m | 20m | 25m | 30m | 35m | 40m | 45m | 50m | 55m | 60m | 90m | 2h | 3h | 4h | 5h | 6h | 7h | 8h | 9h | 10h | 12h | 20h |
|--------|------|------|------|------|------|------|------|------|------|------|------|------|------|------|------|------|------|------|------|------|------|------|------|------|
| 1,80 | 7,34 | 4,37 | 3,52 | 2,81 | 2,23 | 2,05 | 1,82 | 1,64 | 1,47 | 1,39 | 1,29 | 1,19 | 0,89 | 0,77 | 0,56 | 0,45 | 0,38 | 0,32 | 0,28 | 0,25 | 0,22 | 0,21 | 0,18 | 0,11 |
| 1,75 | 7,87 | 4,62 | 3,75 | 2,97 | 2,37 | 2,13 | 1,89 | 1,71 | 1,52 | 1,44 | 1,32 | 1,22 | 0,92 | 0,79 | 0,58 | 0,46 | 0,39 | 0,33 | 0,28 | 0,25 | 0,23 | 0,21 | 0,18 | 0,12 |
| 1,70 | 8,21 | 4,83 | 3,86 | 3,08 | 2,46 | 2,19 | 1,98 | 1,75 | 1,57 | 1,47 | 1,36 | 1,25 | 0,94 | 0,81 | 0,58 | 0,46 | 0,39 | 0,33 | 0,29 | 0,26 | 0,23 | 0,22 | 0,19 | 0,12 |
| 1,65 | 8,60 | 5,04 | 4,00 | 3,17 | 2,58 | 2,25 | 2,03 | 1,83 | 1,61 | 1,50 | 1,40 | 1,29 | 0,98 | 0,81 | 0,58 | 0,47 | 0,40 | 0,33 | 0,29 | 0,26 | 0,23 | 0,22 | 0,19 | 0,12 |
| 1,60 | 8,79 | 5,20 | 4,12 | 3,27 | 2,62 | 2,30 | 2,04 | 1,84 | 1,64 | 1,52 | 1,41 | 1,30 | 0,98 | 0,82 | 0,59 | 0,47 | 0,40 | 0,33 | 0,29 | 0,26 | 0,23 | 0,22 | 0,19 | 0,12 |

Constant Power Discharge - Watts per Block at 25°C

| V/Cell | 5m | 10m | 15m | 20m | 25m | 30m | 35m | 40m | 45m | 50m | 55m | 60m | 90m | 2h | 3h | 4h | 5h | 6h | 7h | 8h | 9h | 10h | 12h | 20h |
|--------|------|------|------|------|------|------|------|------|------|------|------|------|------|------|------|------|------|------|------|------|------|------|------|------|
| 1,80 | 77,1 | 46,2 | 37,7 | 30,1 | 23,9 | 22,2 | 19,7 | 17,8 | 16,0 | 15,2 | 14,2 | 13,2 | 9,89 | 8,65 | 6,37 | 5,13 | 4,39 | 3,73 | 3,27 | 2,90 | 2,65 | 2,48 | 2,16 | 1,36 |
| 1,75 | 82,3 | 48,8 | 40,0 | 32,0 | 25,3 | 23,0 | 20,4 | 18,5 | 16,5 | 15,7 | 14,5 | 13,5 | 10,2 | 8,86 | 6,53 | 5,27 | 4,53 | 3,80 | 3,31 | 2,97 | 2,71 | 2,51 | 2,20 | 1,37 |
| 1,70 | 85,6 | 50,8 | 41,2 | 33,1 | 26,5 | 23,5 | 21,3 | 18,9 | 17,0 | 16,0 | 14,8 | 13,8 | 10,4 | 8,95 | 6,58 | 5,29 | 4,53 | 3,82 | 3,34 | 2,99 | 2,74 | 2,53 | 2,21 | 1,37 |
| 1,65 | 89,5 | 52,9 | 42,6 | 34,0 | 27,4 | 24,2 | 21,7 | 19,7 | 17,4 | 16,3 | 15,2 | 14,1 | 10,8 | 8,99 | 6,60 | 5,34 | 4,55 | 3,82 | 3,34 | 3,01 | 2,76 | 2,55 | 2,21 | 1,38 |
| 1,60 | 91,1 | 54,3 | 43,7 | 34,7 | 28,1 | 24,6 | 21,8 | 19,8 | 17,7 | 16,4 | 15,3 | 14,2 | 10,8 | 9,04 | 6,62 | 5,34 | 4,58 | 3,84 | 3,38 | 3,01 | 2,76 | 2,55 | 2,21 | 1,40 |

Revision: 201509

Your Wing Dealer :

