



ESL 75-12FT



Application

- Telecom
- Communication Equipment
- Control Equipment
- Medical Equipment
- UPS
- Emergency Power System

General Features

- Easy maintenance and installation
- No need for extra (wrench space) above battery
- Sealed and maintenance free operation
- Non-Spillable construction design
- ABS containers and covers(UL94HB, UL94V-0) optional
- Safety valve installation for explosion proof
- Maximized energy density for installation in relay rack trays
- High quality and high reliability
- Exceptional deep discharge recovery performance
- Flexibility design for multiple install positions

Construction

- Component.....Raw material
- Sealant.....Epoxy Resin
- PositiveLead dioxide
- Safety valveEPDR
- NegativeLead

- TerminalCopper
- ContainerABS
- SeparatorFiber glass
- CoverABS
- ElectrolyteSulfuric acid

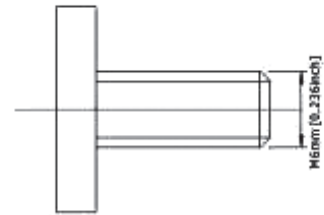

Terminal Dimensions

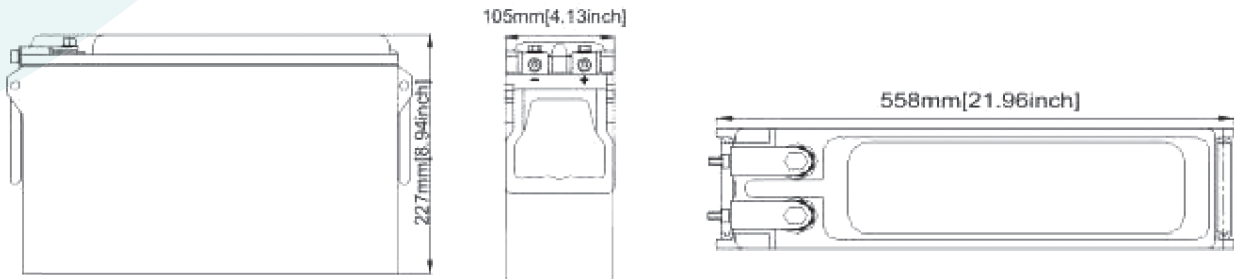

Battery Model	ESL 75-12FT			
Designed Floating Life	12 Years			
Capacity (25°C)	20HR(4A, 1.80V)	10HR(7.5A, 1.80V)	5HR(13.8A, 1.75V)	1HR(45A, 1.60V)
	80AH	75AH	69AH	45AH
Dimensions	Length	Width	Height	Total Height
	558mm(21.97inch)	105mm(4.13inch)	227mm(8.94inch)	227mm(8.94inch)
Approx. Weight	31Kg (68.2 lbs)			
Internal Resistance	Full charged at 25°C: 0.00533 Ohm			
Self Discharge	3% of capacity declined per month at (25°C)			
Capacity Affected by Temp. (20HR)	40°C	25°C	0°C	-15°C
	102%	100%	85%	65%
Charge Voltage (25°C)	Cycle use		Float use	
	14.1-14.4V(-30mV/°C), max. Current: 19.5A		13.5V(-20mV/°C)	

Charge Characteristics

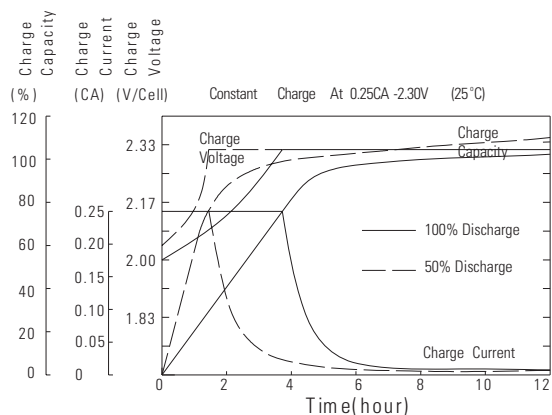

Discharge Characteristics

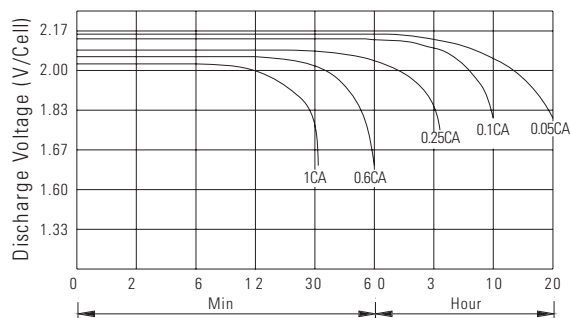

Relationship of OCV and state of charge

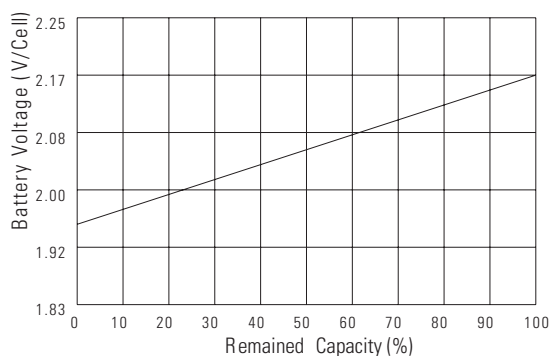

Self Discharge Characteristics

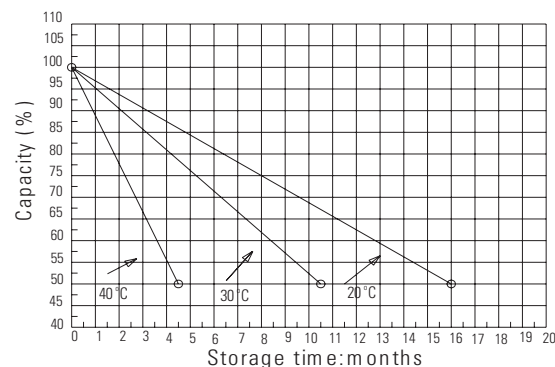

Constant current discharge ratings-amperes at 25°C

FV/Time	5MIN	10MIN	15MIN	30MIN	1HR	3HR	5HR	10HR	20HR
1.60V	263	180	131	78.8	49.5	20.5	14.3	7.95	3.95
1.67V	236	164	128	76.5	49.4	20.4	14.2	7.83	3.94
1.70V	224	158	123	75.0	49.3	20.4	14.2	7.77	3.94
1.75V	200	146	116	73.5	48.8	20.3	14.1	7.64	3.92
1.80V	180	136	111	71.3	48.2	20.2	14.0	7.51	3.78
1.85V	137	112	96.0	65.6	47.6	20.1	13.8	7.37	3.56

Constant power discharge ratings-watts at 25°C

FV/Time	5MIN	10MIN	15MIN	30MIN	1HR	3HR	5HR	10HR	20HR
1.60V	433	299	233	149	97.5	39.3	27.4	15.9	7.91
1.67V	410	295	230	146	94.3	39.3	27.4	15.7	7.88
1.70V	383	287	227	142	91.8	39.3	27.4	15.5	7.88
1.75V	357	269	213	138	91.0	38.7	27.1	15.3	7.84
1.80V	320	250	200	134	89.4	38.2	26.6	15.0	7.56
1.85V	257	207	175	123	88.6	38.0	26.3	14.7	7.11